

PLASKOLITE

MULTIWALL SHEET

INSTALLATION GUIDE

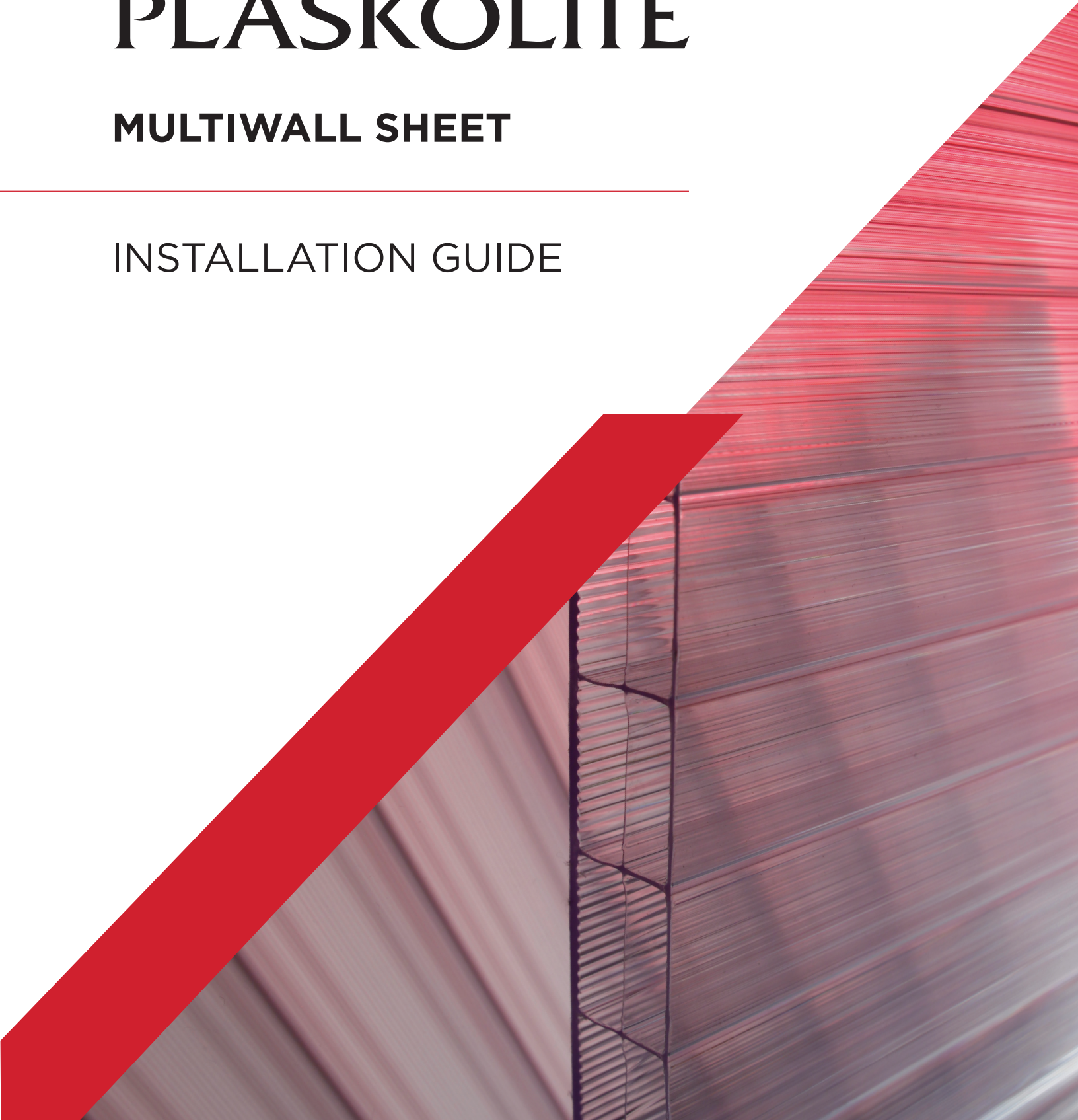

Preparation (roof installation)

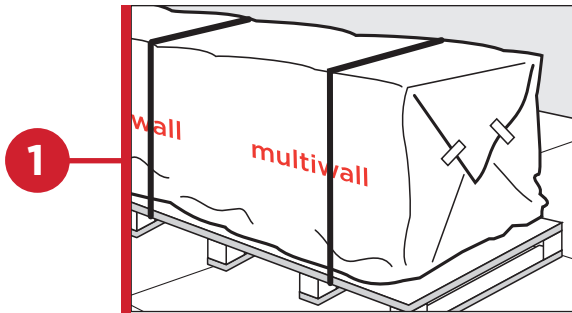

1) Sheet storage recommendation: Store in dry, dark & well ventilate area, with NO EXPOSURE to sunlight, wind, dirt or hard objects to prevent damage.

Outdoors sheets should be covered with an opaque material that provides protection from the sun. Storage of sheets exposed to sunlight will cause the protective polyethylene film to bake onto the sheet, and it will not be able to be removed.

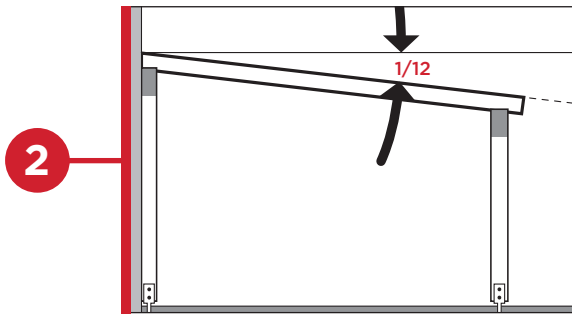

2) We recommend 1" for 12" of slope to allow rainwater runoff. This has the added benefit of maintaining seal integrity and the glazing is naturally cleaned by rainwater. The chosen supporting structure must be non-warping.

Please note: The flutes must run in the direction of the slope.

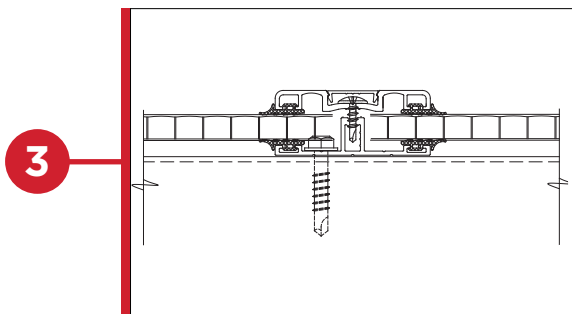

3) Place the sheets with the UV protected side toward the sun. Install the base section of the connecting profiles to the rafter. The glazing bar edge seals against the rafter and the sheet.

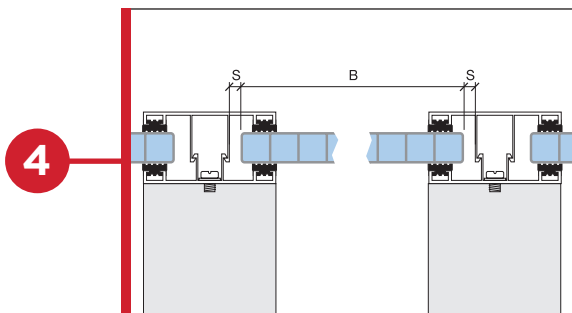

4) The sheet width (B) is calculated as the total of the rafter spacing, glazing bar dimensions, and sheet expansion allowance. (1/30" / foot for polycarbonate)

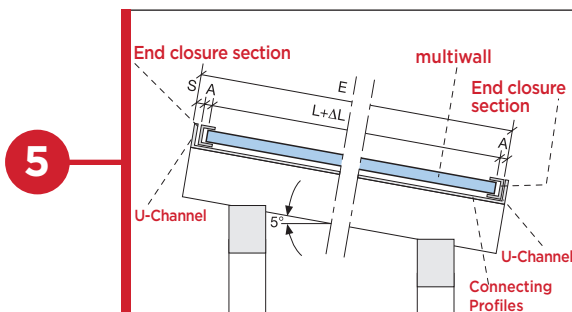

5) The sheet length (L) is defined as:

E = the span

A = sheet edge engagement

S = allowance for expansion

Delta L represents sheet lengths available for sale

Calculation Example:

Sheet size: 4' x 8'

Expected high temperature: 100°F

Expected low temperature: -10°F

Temperature difference: delta T. 110°F

Expansion in width: a. delta T. W = 0.0000375 x 110°F x 48" = 0.198"

Expansion in length: a. delta T. L = 0.0000375 x 110°F x 96" = 0.396"

Cutting to size (roof installation)

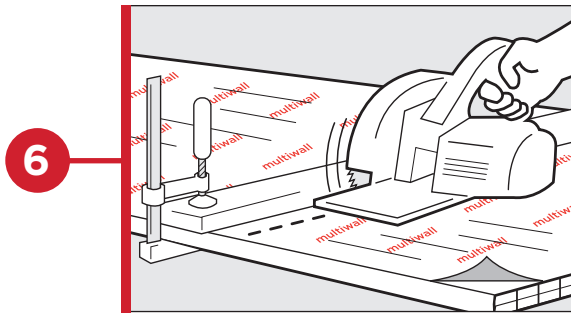

6) Mark dimensions on the masking which should not be removed until completing all fabrication work and after installation. Cut sheets using a conventional circular saw or table saw equipped with a carbide tip blade. For more information, refer to the Polycarbonate Fabrication Guide.

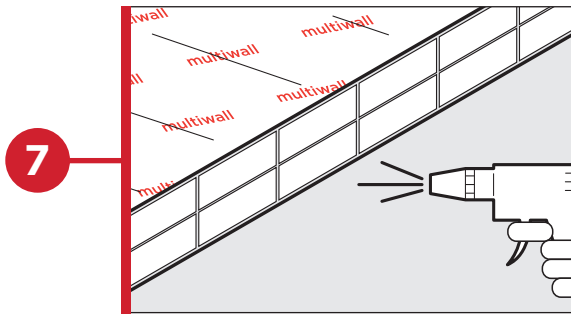

7) Plastic chips and dust that collect in the channels, as a result of cutting, can be blown out with clean, compressed air.

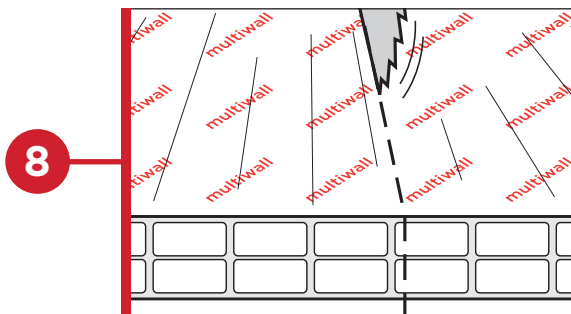

8) Where the sheet needs to be trimmed, cut as close to the next rib to ensure a rigid clamping profile.

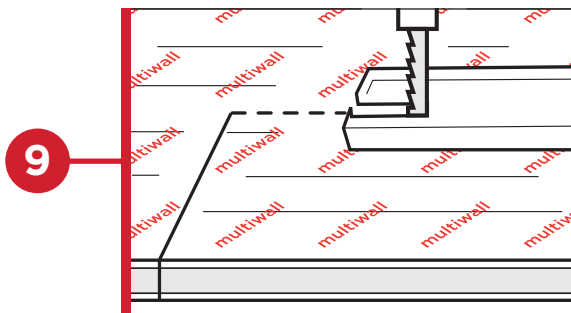

9) Corner cutouts are often required (e.g. for pipes, ventilation, etc.). Use a jig saw (without pendulum stroke). Drilling can be performed with twist drills (point angle at 110°-130°), conical or step drills.

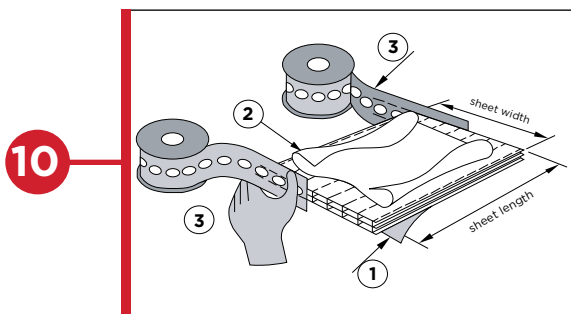

10) AntiDUST™ tape is a non-woven system used for sealing the top and bottom edges of multiwall sheets. It is specifically designed to stop mold, algae, insects and dust from accumulating within multiwall sheets. Advantages of AntiDUST tape over competitive products: Ease of application, proper drainage of condensation, maintains clarity, durable and long life of tape materials.

Roof Installation

11

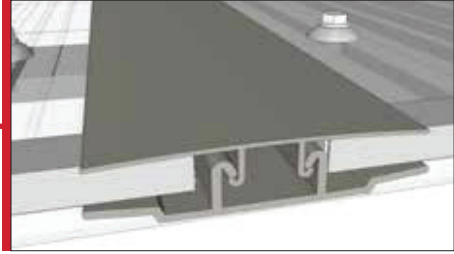

11) Position the connecting profile cap in place with a shock absorbing support under the sheet. Use a rubber mallet to connect it to the base. For Aluminum Glazing Systems, anchor the cap profile to the base with approved screws.

12

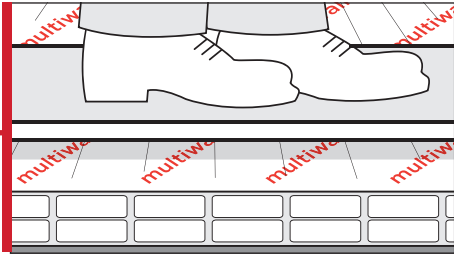

12) Avoid walking on the sheets. If necessary, place a thick plank across the sheet.

13

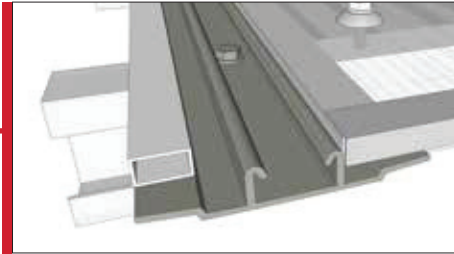

13) Slide the base connection profile underneath the sheet edge. This profile is fastened in the center with screws. Depending on the glazing system, a cover section is then clipped on.

14

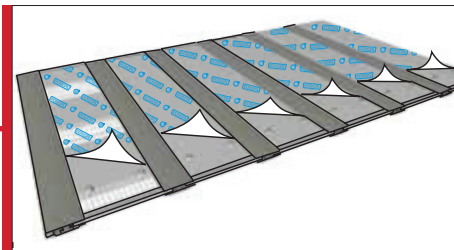

14) Finally, remove the masking from the Multiwall sheets. It should not be exposed to weathering for more than 24 hours.

Multiwall compatible products

Recommended Sealants, Gaskets, and Tapes

Product Type	Product Names	Manufacturer
Silicone	Dow 795 • Dow 995 • Dow 999	Dow-Corning Corp • Midland, MI • (800) 346-9882
Silicone	Silpruf	Momentive Performance Materials • Waterford, NY • (877) 943-7325
Gasket	EPDM (60, 70D)	Tremco Columbus, OH (800) 321-6357

Many other glazing materials are commercially available which are compatible with Multiwall Polycarbonate Sheet. Please contact those manufacturers for their recommended products.

These suggestions and data are based on information we believe to be reliable. They are offered in good faith, but without guarantee, as conditions and methods of use are beyond our control. We recommend that the prospective user determines the suitability of our materials and suggestions before adopting them on a commercial scale.

PLASKOLITE

400 W Nationwide Blvd, Suite 400
Columbus, OH 43215
800.848.9124 • Fax: 877.538.0754
plaskolite@plaskolite.com
www.plaskolite.com